

Main Floor: 1416 sq. ft.
Upper Floor: 1063 sq. ft.
Lower Floor: 785 sq. ft.
Total: 3264 sq. ft.

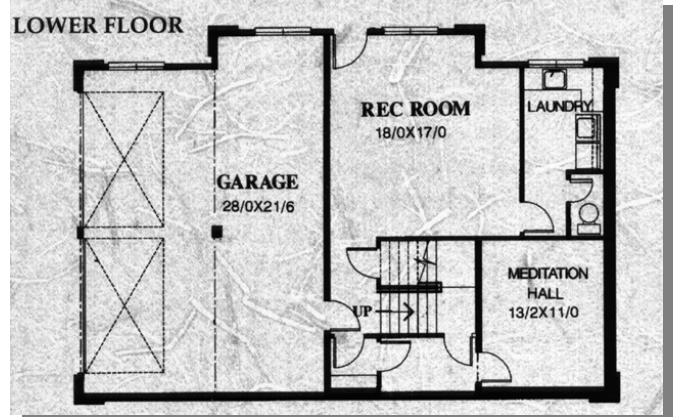
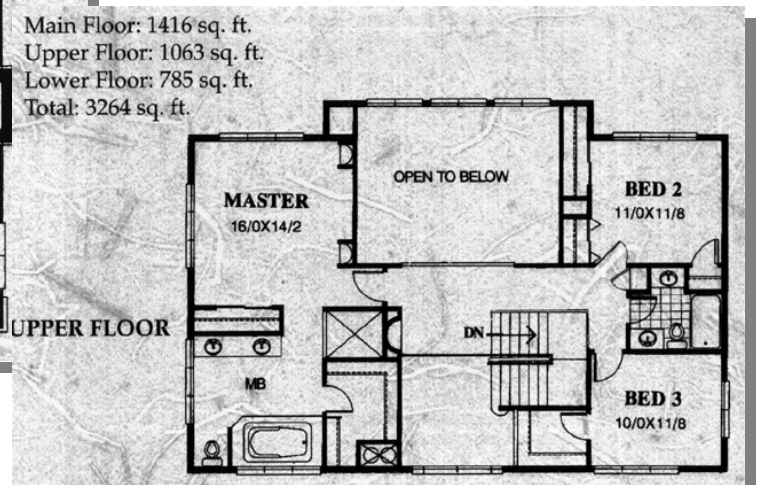

Plan
MSAP-3264

48/0 wide x 41/0 deep
3,264 sq. ft.

"This is my own personal residence. I designed the plan for my family with several goals in mind. I wanted a strong, timeless architecture to lead into large multi-use spaces. I did this with the two story great room you see here, with its formal entertaining ability as well as everyday functionality. I placed a very good sized study accessible from the foyer as well as a deck on the right side of the main floor. The left side has a very nice kitchen and large dining room that again does daily as well as formal duty. Downstairs is a large rec. room, utility and meditation room that could double as storage. The garage is an oversized two car design. Upstairs are three generous bedrooms connected with a sky bridge overlooking the great room and foyer. It is strong, flexible and particularly special to me.."